

## Mac OS

Follow these steps to connect your Mac OS device to the “**Univ of La Verne Wi-Fi Protected**” network for the first time.

**Step 1:** Click on the Wi-Fi icon on the upper-right corner of the menu bar and then select “**Univ of La Verne Wi-Fi Protected**”.

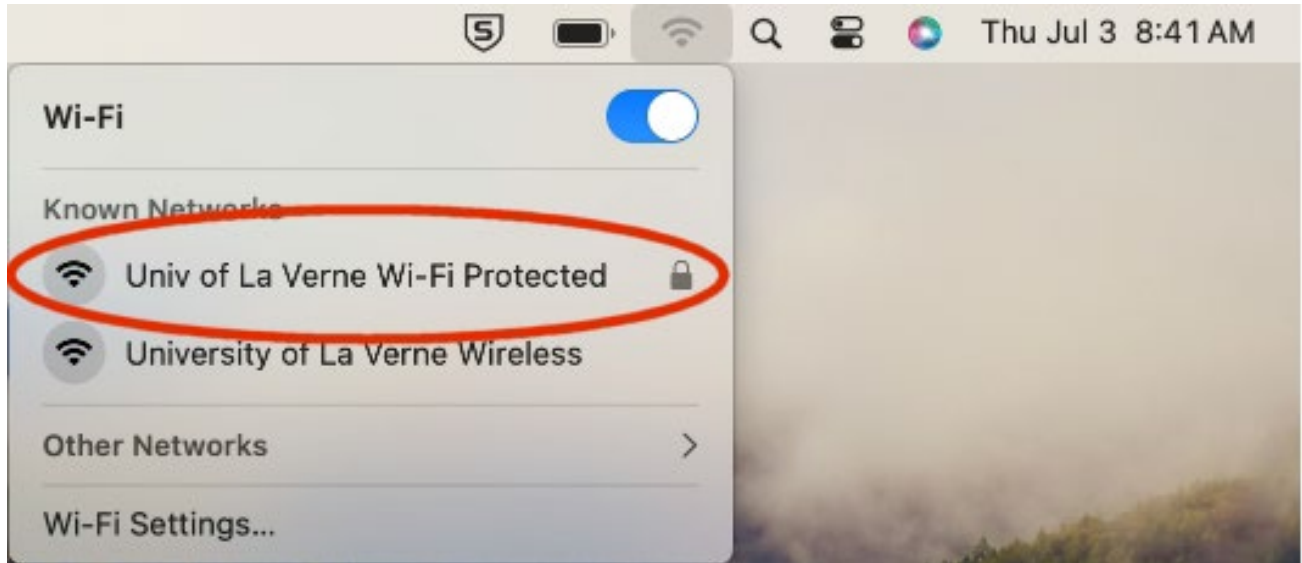

**Step 2:** Enter your University of La Verne **email** credentials and click **OK**.

- If your **username is 20 characters or fewer**, enter just your username (example: john.smith)
- If your **username is longer than 20 characters**, enter your **full email address** (example: alexandra.jones-smith@laverne.edu)

Note: If you do not have a University of La Verne email account, [click here](#) for guest Wi-Fi access instructions.

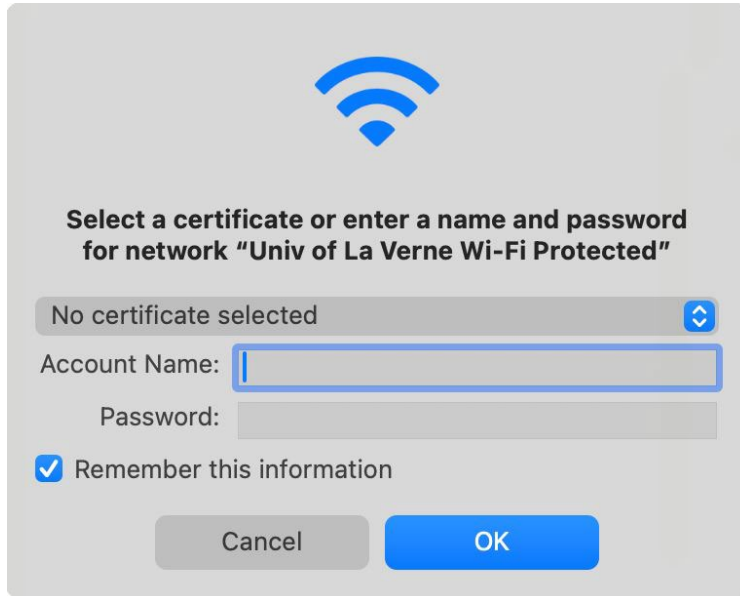

A dialog box with a blue Wi-Fi icon at the top. The text reads: "Select a certificate or enter a name and password for network 'Univ of La Verne Wi-Fi Protected'". Below this is a dropdown menu showing "No certificate selected". Underneath are two input fields: "Account Name:" and "Password:". A checkbox labeled "Remember this information" is checked. At the bottom are "Cancel" and "OK" buttons.

**Step 3:** A **Verify Certificate** window will appear (it should look similar to the example below). Click **Continue**.

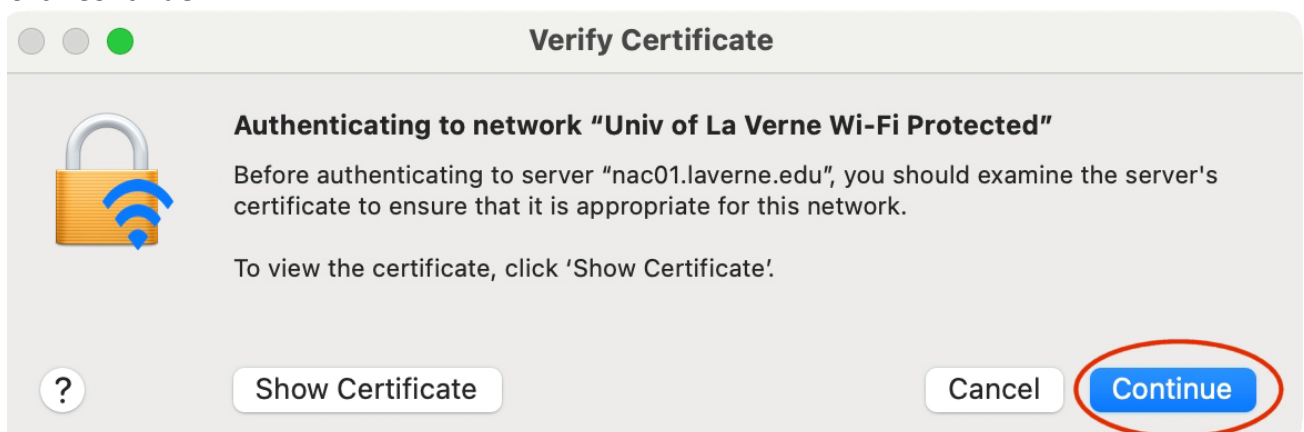

A window titled "Verify Certificate" with a yellow padlock icon and a blue Wi-Fi icon. The text reads: "Authenticating to network 'Univ of La Verne Wi-Fi Protected'". Below this is a paragraph: "Before authenticating to server 'nac01.laverne.edu', you should examine the server's certificate to ensure that it is appropriate for this network." Another line of text says: "To view the certificate, click 'Show Certificate'". At the bottom are four buttons: a question mark icon, "Show Certificate", "Cancel", and "Continue". The "Continue" button is circled in red.

**Step 4:** Click on the **Use Password...** button and then enter your Mac administrator username and password. Click **Update Settings** to save the certificate.

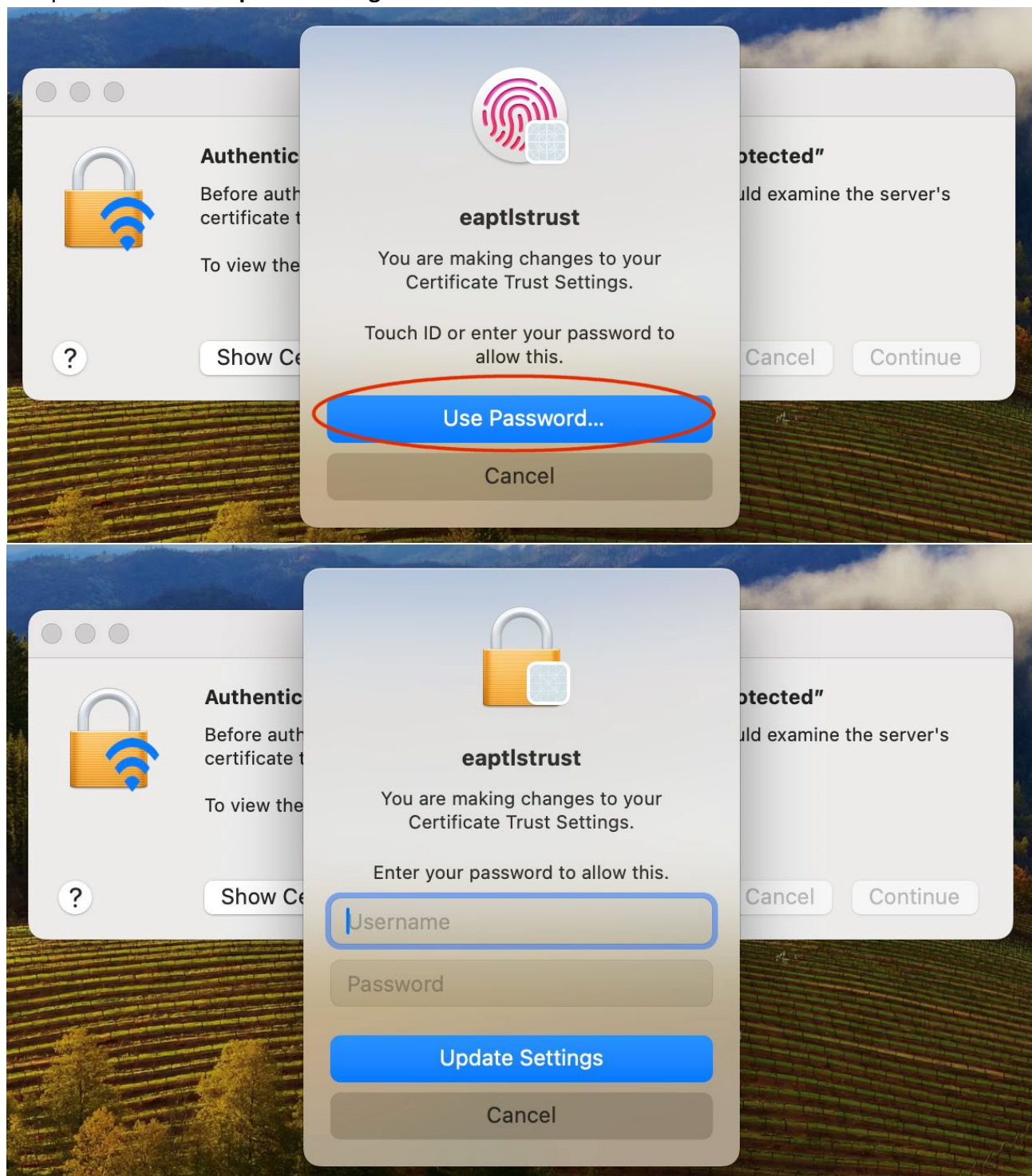

**Step 5:** You are now connected to the “**Univ of La Verne Wi-Fi Protected**” network. To confirm, click on the Wi-Fi icon again in the menu bar.

